

Zenith Aroma Diffusers instruction manual



Thank you for your purchase and Welcome to the world of Zenith Aroma Diffuser. In a simple few steps you will be able to enjoy the ambiance you are looking for.

Through the advanced technology of cold air Atomization, your sleek, elegant and discreet diffuser is the perfect complement for your home or office.

Please follow the following tips, safety guidelines and maintenance to get the most out of the Zenith experience.

This package contains

- Zenith Aroma Diffuser
- Remote Control
- AC Power Adapter
- Empty Bottle
- Spare Nozzle

Setting up your diffuser

- Open your diffuser by turning upper part of the device in a counterclockwise motion, while holding the bottom half
- Add your oils selection to be diffused in empty bottle provided
- Screw the bottle counterclockwise in the diffuser (rotate to fix, making sure bottle is straight and tight)
- The oil bottle must be attached to diffuser before programming the timer.

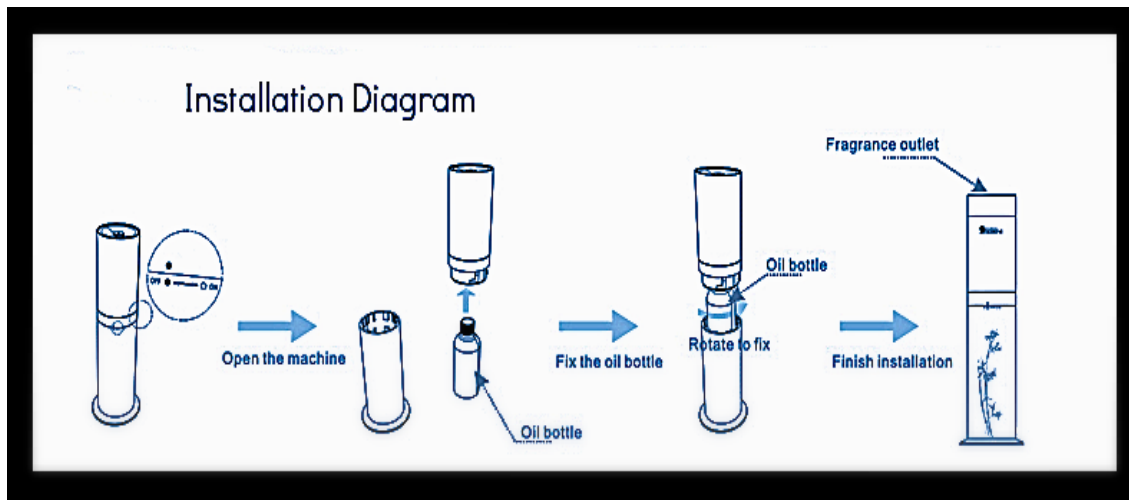

Connect the power adapter

The indicator Lights

Blue Led light – indicates the device is powered on

Green Led Light indicates the scent is being diffused



Remote Control Functions

The remote control provides you with the flexibility to set the aroma concentration, atomization amount, running time and ON/OFF setting.

By default, the unit will run continuously, Adjust the settings according to the density desired.

- **【ON】** Press **【ON】** to turn on the machine.
- **【OFF】** Press **【OFF】** to turn off the machine.
- **【AROMA】** When the machine is ON, press **【AROMA】** to adjust the atomization amount.
- **【+】** When the machine is ON, Press **【+】** to increase the density each time you press **【+】** to add a Level until biggest.
- **【-】** When the machine is ON, Press **【-】** to decrease the density, each time you press **【-】** to reduce a Level until smallest.
- **【20%】 【35%】 【50%】 【65%】 【80%】 【95%】** When the machine is ON, press the buttons to adjust the aroma concentration. Such as: **【20%】** means work for 40 seconds and stop for 160 seconds; **【35%】** means work for 70 seconds and stop for 130 seconds.
- **【1h】 【4h】 【8h】** When the machine is ON, Press **【1h】 【4h】 【8h】** to adjust the running time.

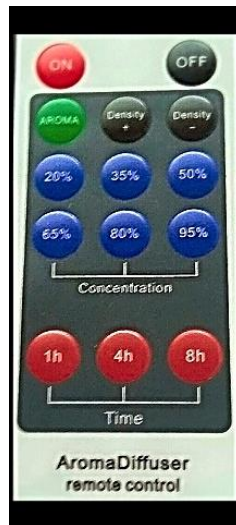

Resetting the remote control

Unplug the diffuser from power outlet

Press and hold for 10 seconds the 35% button

Turn on the power, the 2 lights will shine (Success)

Getting the most out of your Unit

The Zenith Aroma Diffuser should always be used in upright position. Tilting it while oil bottle is attached may cause damage to the device and parts.

Place the unit on its own away from windows and air vents so the scent can circulate freely.

The Zenith should be cleaned regularly to promote optimal performance. (Every 2 months recommended). To clean the unit, fill the empty oil bottle with rubbing alcohol or ethanol 20 ml and attach to diffuser, run the unit for 10-15 minutes to ensure the alcohol filters through the whole device. Turn off machine and pour away the alcohol.

Clean the exterior with a damp cloth to remove oil stains and fingerprints. Do not use harsh or abrasive cleaning products.

Do not add water to essential oil and do not keep the device close to water or outdoors. Do not run the diffuser on empty. If you need to change the oil or add oil, then please cut down the power supply

Warranty:

This unit comes with a limited 12-month warranty.

Only use 100% pure essential oils. No Carriers, No absolutes (too Thick) **Using different oil blends that are too thick will VOID the warranty.**

Aroma Oil diffusers oil collections are a perfect complement to the Zenith diffuser and highly recommended.

Damage caused by improper maintenance will not be acceptable under warranty, but spare parts are available,

Please contact us at: <https://www.aromaoidiffusers.com/contact/>

Products must be registered within 14 days

Please visit us at: aromaoidiffusers.com

Aromaoidiffusers.com

P. 905.235.3578

Canada USA

Aromaoildiffusers.com

P. 905.235.3578

Canada USA